

MS9276

FED SUP CLASS
5310

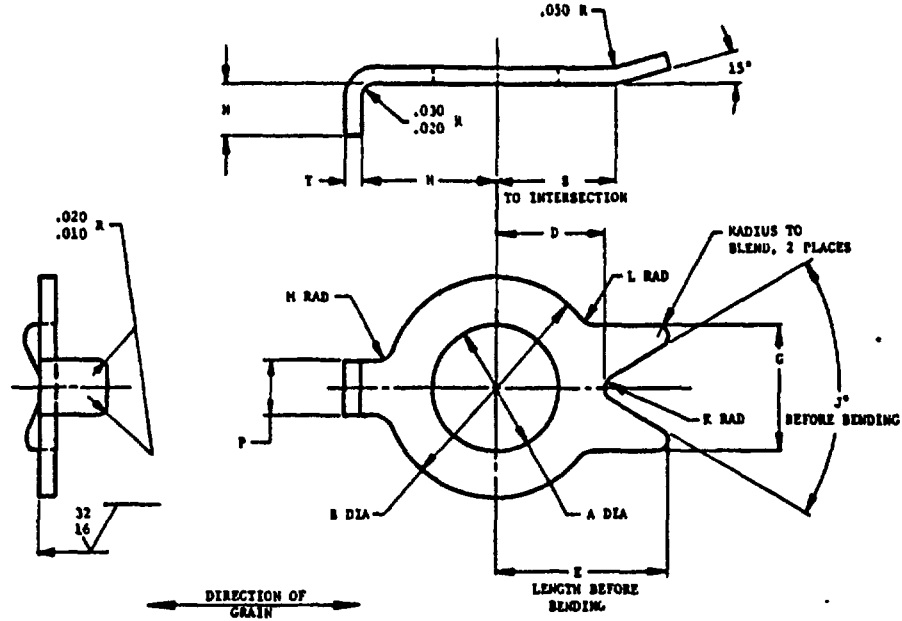

| PART NO. | NOM SIZE | A | | B | | D | | E | | G | | H | | J | | K | | L | | M | | N | | P | | S | | T | | APPROX WEIGHT LB/100 |
|-----------|----------|--------|--------|--------|--------|--------|--------|--------|--------|--------|--------|--------|------|------|------|------|-------|---|--|---|--|---|--|---|--|---|--|---|--|----------------------|
| | | + .005 | + .010 | - .000 | - .000 | + .005 | + .010 | - .000 | - .000 | + .010 | + .010 | ± .005 | ± 2° | | | | | | | | | | | | | | | | | |
| MS9276-08 | .164 | .170 | .210 | .160 | .275 | .175 | .186 | 50° | .015 | .037 | .037 | .080 | .080 | .180 | .019 | .025 | .041 | | | | | | | | | | | | | |
| MS9276-09 | .190 | .195 | .270 | .190 | .295 | .200 | .226 | 60° | .015 | .037 | .037 | .095 | .110 | .210 | .019 | .025 | .065 | | | | | | | | | | | | | |
| MS9276-10 | .230 | .255 | .440 | .220 | .350 | .250 | .270 | 60° | .025 | .040 | .040 | .100 | .110 | .240 | .028 | .036 | .128 | | | | | | | | | | | | | |
| MS9276-11 | .312 | .320 | .495 | .250 | .410 | .280 | .330 | 80° | .030 | .040 | .050 | .100 | .140 | .280 | .028 | .036 | .160 | | | | | | | | | | | | | |
| MS9276-12 | .375 | .390 | .560 | .280 | .450 | .320 | .370 | 60° | .030 | .040 | .050 | .140 | .140 | .320 | .028 | .036 | .182 | | | | | | | | | | | | | |
| MS9276-13 | .438 | .450 | .685 | .345 | .525 | .390 | .420 | 60° | .045 | .040 | .050 | .150 | .170 | .380 | .032 | .040 | .246 | | | | | | | | | | | | | |
| MS9276-14 | .500 | .515 | .745 | .375 | .590 | .425 | .470 | 60° | .050 | .050 | .050 | .150 | .200 | .420 | .032 | .040 | .396 | | | | | | | | | | | | | |
| MS9276-15 | .562 | .575 | .870 | .440 | .640 | .500 | .545 | 80° | .050 | .050 | .075 | .150 | .200 | .480 | .032 | .040 | .332 | | | | | | | | | | | | | |
| MS9276-16 | .625 | .640 | .930 | .470 | .680 | .530 | .570 | 80° | .050 | .050 | .075 | .150 | .200 | .500 | .032 | .040 | .392 | | | | | | | | | | | | | |
| MS9276-17 | .750 | .765 | 1.055 | .530 | .730 | .550 | .670 | 90° | .050 | .060 | .100 | .150 | .230 | .570 | .032 | .040 | .709 | | | | | | | | | | | | | |
| MS9276-18 | .875 | .890 | 1.245 | .625 | .860 | .600 | .795 | 90° | .050 | .060 | .100 | .150 | .260 | .680 | .032 | .040 | .821 | | | | | | | | | | | | | |
| MS9276-19 | 1.000 | 1.015 | 1.430 | .715 | .950 | .650 | .870 | 90° | .100 | .060 | .100 | .150 | .290 | .780 | .032 | .040 | 1.060 | | | | | | | | | | | | | |

Review activities:
Navy - SM, CG, (XN)
Air Force - II

This military standard is approved by the Department of the Air Force and the Bureau of Naval Weapons and is mandatory for use by these activities. All other military activities are required to employ this standard where suitable.

1. MATERIAL: CORROSION RESISTANT STEEL AMS 5510.
2. HEAT TREATMENT FORMED WASHERS SHALL BE STRESS RELIEVED AT 1400 F ± 25 FOR 30 MINUTES IN A PROTECTIVE ATMOSPHERE FOLLOWED BY AIR COOL.
3. SURFACES WITHIN DIA B ARE TO BE FLAT WITHIN .005 AND OF UNIFORM THICKNESS WITHIN .002.
4. DIA A AND B TO BE CONCENTRIC WITHIN .010 FIR
5. REMOVE BURRS AND SHARP EDGES.
6. SURFACE TEXTURE ANSI B46.1-1962; UNLESS OTHERWISE SPECIFIED SURFACES TO BE 125 MICROINCHES.
7. IDENTIFICATION MARK PART NUMBER AND MANUFACTURER'S IDENTIFICATION ON CONTAINER.
8. DIMENSIONS IN INCHES UNLESS OTHERWISE SPECIFIED, TOLERANCES: LINEAR DIMENSIONS ± .010 ANGULAR DIMENSIONS ± 5°.
9. DO NOT USE UNASSIGNED PART NUMBERS.

AS & AIS ARE SOCIETY OF AUTOMOTIVE ENGINEERS, INC. PUBLICATIONS.
THIS STANDARD WAS DEVELOPED COOPERATIVELY WITH THE MILITARY SERVICES BY THE SAE AEROSPACE PART STANDARDS DIVISION.

| | | |
|--|---|-----------------------------|
| P.A. USAF - 82 Other Cust NAVY - AS ARMY - AV | TITLE WASHER, KEY-CRES, AMS 5510, 180° LOCKING | MILITARY STANDARD MS9276 |
| PROCUREMENT SPECIFICATION NONE | SUPERSEDES | SHEET 1 OF 1 |

DD FORM 672-1 (Limited circulation)
AND use only

PREVIOUS EDITIONS OF THIS FORM ARE OBSOLETE

5310-0567

APPROVED 15 Mar 65
REVISED 1 Aug 69 12 Jun 73